

# Exteriors and Floor Plans



CRYSTAL COVE III



MOUNT SHASTA 4



SARATOGA 3



WESTHAVEN

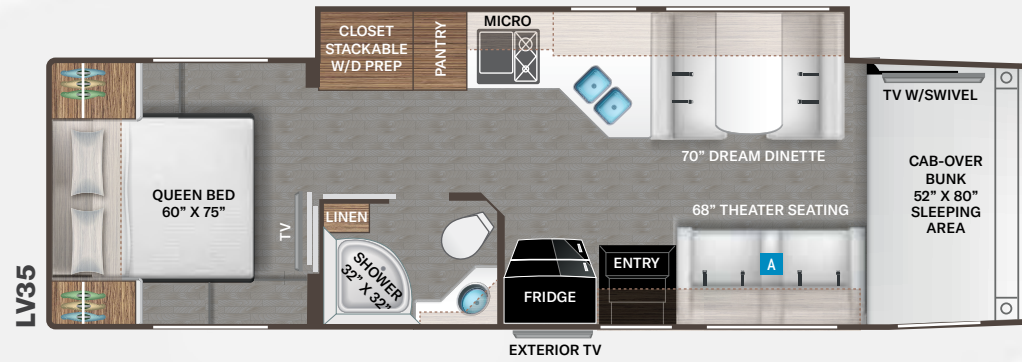
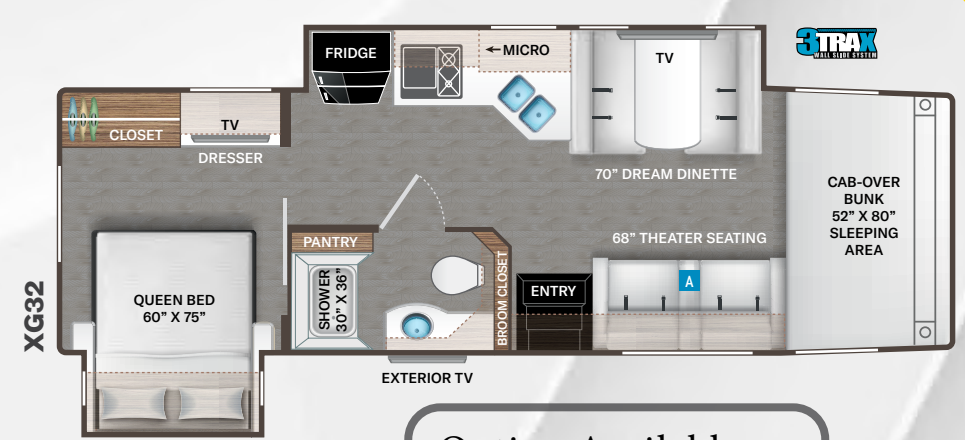
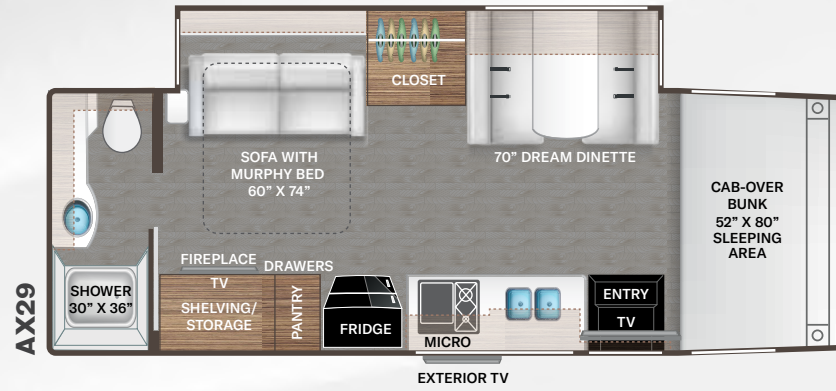

Option Available on Select Floor Plans:

OPTIONAL 68" SOFA

## Interiors



### Optional Cabinetry:



Use your phone's camera to find out more information. Just scan the code!



## Featured Highlights

### CONSTRUCTION & EXTERIOR

- Ford® Chassis - F550 - Power Stroke™ 4 X 4 Turbo Diesel / 6.7L Power Stroke V8 (AX29 & XG32)
- Ford® Chassis - F600 - Power Stroke™ 4 X 4 Turbo Diesel / 6.7L Power Stroke V8 (LV35 & RS36)
- Welded Tubular Aluminum Floor, Roof & Sidewall Cage Construction
- Premium One-Piece Crossflex™ Roof
- Full-Body Paint Package with Gel Coated Sidewalls
- Invisible Front Paint Protection
- Automatic Leveling Jacks with Touchpad Controls
- Rotocast Storage Compartments
- Flush Mount Radius Luggage Doors
- MEGA-Storage Compartment (AX29 & LV35)
- Power Patio Awning with Integrated LED Lighting
- Slideout Room Awnings
- Roof Ladder
- Electric Entry Step
- Automatic Courtesy Lights Over Cab Entry
- Frameless Windows
- 10,000-lb. Trailer Hitch with 7-pin Round Connector (XG32)
- 12,000-lb. Trailer Hitch with 7-pin Round Connector (AX29, LV35 & RS36)

### AUTOMOTIVE & COCKPIT

- SYNC® 4 Enhanced Voice Recognition Communications & Entertainment System
- 8" Color LCD Capacitive Touchscreen with Swiping Capability, 911 Assist, AppLink, Smart-Charging USB Ports
- Tire Pressure Monitoring System (LV35 & RS36)
- AM/FM Radio, SYNC® with MyFord
- FordPass™ Connect 4G Wi-Fi Modem
- Heated/Remote Exterior Mirrors
- Rearview Mirror with Back-up Monitor
- Side View Camera System
- Emergency Engine Start Switch

- Adjustable Power Driver & Manual Passenger Captain's Chairs with Center Armrests, Headrests and Walk-Thru to Coach
- Adjustable Accelerator & Brake Pedals
- Power Windows & Door Locks
- Audible Lane Departure Warning & Pre-Collision Assist with Automatic Emergency Braking (AEB) and Forward Collision Warning
- Remote Start
- Cruise Control
- Tilt Steering Wheel
- Automatic Headlights
- Fog Lamps
- Map Light
- Powered Sky View Shade in Cab Overhead
- Keyless Entry System
- All Weather Cab Floor Mats
- Privacy Curtain
- Fiberglass Running Boards
- Valve Stem Extenders
- Matte Black Wheels

### INTERIOR

- Residential Linoleum Throughout
- 84" Interior Ceiling Height
- Soft Touch Vinyl Ceiling
- LED Lighting
- Ceiling Ducted Air Conditioning System
- Baymont Cabinetry with Flat Panel Cabinet Doors & Nickel Finish Hardware
- Full Extension Soft Close Metal Ball-Bearing Drawer Guides
- Manual Roller Shades - Day/Night in Living Area & Night Shades in the Bedroom
- Leatherette Dream Dinette® Booth with Cup Holders
- Single Child Safety Tether in Dinette
- Wireless Phone Charger with USB Plug on Dinette Table Top
- Pressed Laminate Countertops in Select Areas
- Leatherette Power Reclining Theater Seating with Footrests, Heat, Massage & USB Charging Ports (XG32, LV35 & RS36)
- Leatherette Sofa with Electric Murphy-Bed (AX29)

- Electric Fireplace with Remote Control (AX29)

### INTERIOR OPTIONS

- Leatherette Sofa-Bed IPO Theater Seats (XG32, LV35 & RS36)
- Brighton Two-Tone Cabinetry with Flat Panel Cabinet Doors & Chrome Finish Hardware

### KITCHEN

- Double Door Residential Refrigerator
- 2-Burner High-Output Gas Range with Single Induction Cooktop
- Stainless Steel 30" Over-the-Range Convection Microwave Oven
- Solid Surface Countertops
- Pop-Up Wireless Phone Charger with Outlets & USB Charge Ports
- Kitchen Countertop LED Accent Lighting
- Decorative Tile Backsplash
- Stainless Steel Double Bowl Sink with Single Handle Faucet & Pull-Down Sprayer
- Pantry
- Waste Basket
- 12-volt High Capacity Power Vent with Cover

### BEDROOM & BATHROOM

- King Size Bed (RS36)
- Queen Size Bed (XG32 & LV35)
- Headboard, Bedspread & Pillow Shams (XG32, LV35, & RS36)
- USB Charge Ports in Bed Base (XG32, LV35, & RS36)
- Queen Size Murphy Bed (AX29)
- USB Charge Port in Night Stand (AX29)
- Bedroom 110-volt Outlet on Inverter for CPAP Machine
- Bunk Beds - Converts to Closet (RS36)
- Shower with Glass Door
- Stainless Steel Bathroom Sink
- Foot Flush Toilet (AX29)
- Macerator Toilet (XG32, LV35 & RS36)
- Power Bath Vent

### ENTERTAINMENT

- 40" Smart TV on Manual Swivel above Entry Door (AX29)
- 40" Smart TV on Manual Swivel in Cab-Over (LV35 & RS36)
- 40" Smart TV in Living Area (XG32)
- 32" Smart TV in Bedroom
- USB Charge Port with TV Prep in Bunk Bed (RS36)
- Exterior 32" TV on Swivel Bracket with Bluetooth® Built-in Sound Bar and Radio
- Bluetooth® Coach Radio System in Bedroom
- Cable TV Ready
- Satellite Mounting Backer in Roof
- Winegard® Connect™ 5.0 WiFi Extender / 5G / TV Antenna
- Exterior Kitchen with Refrigerator & Sink (RS36)

### ELECTRICAL & PLUMBING

- Onan® RV QD 6000 Diesel Generator
- Automatic Generator Start
- 50-amp Detachable Shoreline Power Cord
- Automatic Transfer Switch with Power Protection
- 1800-watt Inverter
- Dual Roof Air Conditioners

- Dual Auxiliary House Batteries with Battery Tray - Holds up to Four (4) Batteries
- Battery Disconnect Switch
- 100-watt Solar Charging System with Charge Controller
- Rapid Camp+® Multiplex Electrical Control System with Bluetooth® & 7" Touchscreen
- Whole Coach Water Filtration System
- Tankless Water Heater
- Enclosed & Heated Holding Tanks (XG32, LV35 & RS36)
- Protected Holding Tanks with Heat Pads (AX29)
- Black Tank Flush System
- 360° Siphon® RV Holding Tank Vent Cap
- Washer/Dryer Combo Prep (RS36)
- Outside Shower
- Exterior LP Connection

### ELECTRICAL & PLUMBING OPTION

- Solar Panel Plus+ - Includes Two (2) additional 200-watt Solar Panels (500-watts Total), Two (2) additional Auxiliary House Batteries & 30-amp Charge Controller



P.O. Box 1486, Elkhart, IN 46515  
Sales Department: 800.860.5658



Use your phone's camera to find out more information. Just scan the code!

## Specifications

	AX29	XG32	LV35	RS36
<b>Chassis</b>	Ford F550	Ford F550	Ford F600	Ford F600
<b>Gross Vehicle (GVWR)</b>	19,500	19,500	22,000	22,000
<b>Gross Combined (GCWR)</b>	43,000	43,000	43,500	43,500
<b>Wheel Base</b>	205"	227"	252"	267"
<b>Exterior Length (w/o ladder)</b>	30'-8"	33'-8"	36'-4"	37'-8"
<b>Exterior Height (w/AC)</b>	12'-6"	12'-6"	12'-7"	12'-7"
<b>Exterior Width (w/o mirrors)</b>	99"	99"	99"	99"
<b>Interior Height (living area)</b>	84"	84"	84"	84"
<b>Awning Size</b>	18'	14'	20'	20'
<b>Fuel (gal)</b>	28F / 40R	28F / 40R	28F / 40R	28F / 40R
<b>LPG (lbs)</b>	68.2	68.2	68.2	68.2
<b>Fresh/Waste/Gray Water (gal)</b>	65 / 50 / 50	75 / 40 / 47	75 / 40 / 40	75 / 40 / 40
<b>Water Heater (gal)</b>	Tankless	Tankless	Tankless	Tankless
<b>Furnace (BTUs)</b>	30,000	30,000	30,000	30,000
<b>Exterior Storage Capacity (cu. ft.)</b>	54	78	152	74
<b>Hitch Weight Rating (lbs)</b>	12,000	10,000	12,000	12,000

For a complete listing of available specifications and features, visit: [thormotorcoach.com/omni](http://thormotorcoach.com/omni)

**IMPORTANT-PLEASE READ:** This brochure reflects product design, fabrication, material, components and specifications at the date of printing, which date is disclosed below. Please visit us online at [ThorMotorCoach.com](http://ThorMotorCoach.com) or consult with your selling dealership for the latest in standards, options, specification and technical information. Photographs in the brochure may depict optional equipment or may only be available in certain floor plans. Components, appliances and the chassis may have been manufactured in a calendar year before the vehicle's designated model year. All capacities are approximate. The actual length of the vehicle may differ from that indicated in the brochure due to variances in the manufacturing processes and/or installed components. All dry weights are based on standard model features and do not include optional features or equipment. Component part and appliance manufacturers issue limited warranties covering portions of the vehicle not covered under the limited warranty we issue. Copyright Thor Motor Coach, Inc. © MY 04/29/2024





# Exteriors and Floor Plans



CITYSCAPE PARTIAL PAINT



CRYSTAL COVE III



SARATOGA 3



WESTHAVEN

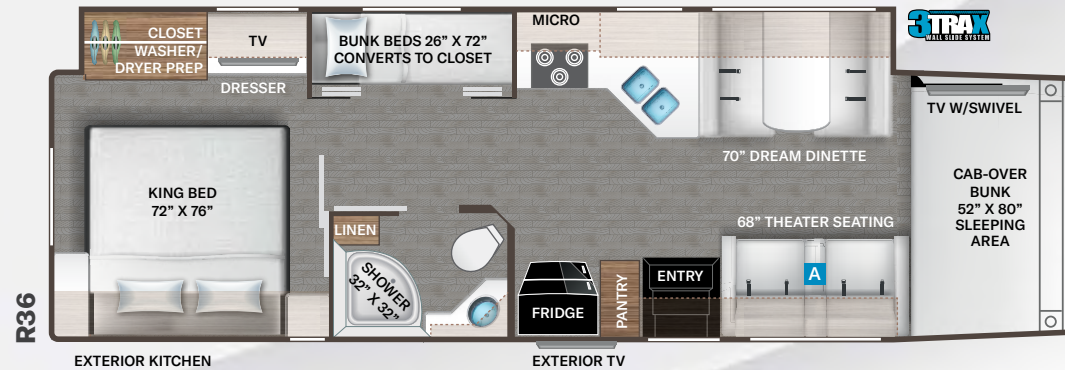
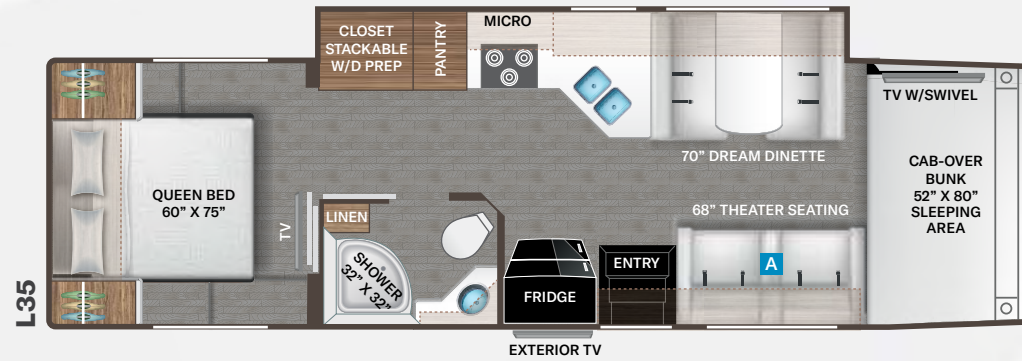
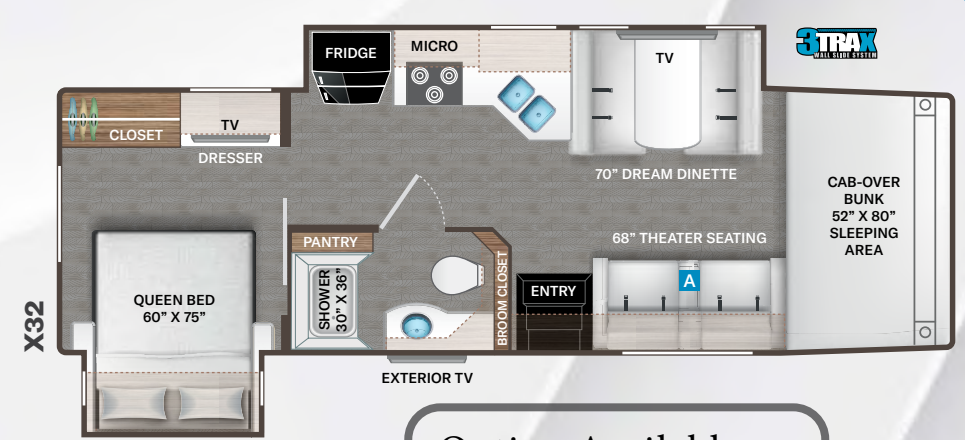
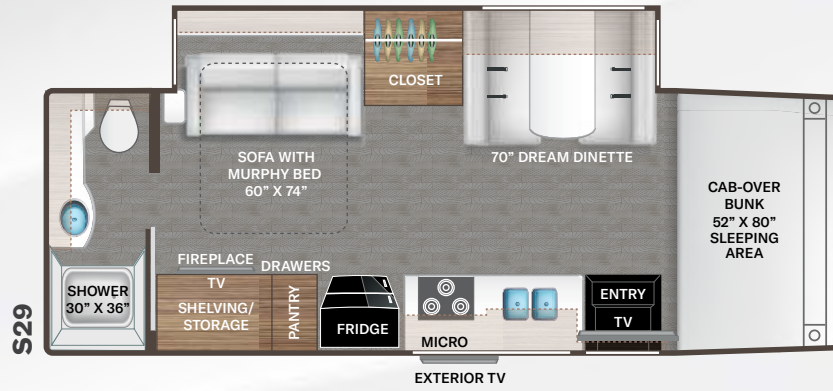

Option Available on Select Floor Plans:

OPTIONAL 68" SOFA

## Interiors



Optional Cabinetry:



Use your phone's camera to find out more information. Just scan the code!



**OMNI**<sup>®</sup>  
Trail

## Featured Highlights

### CONSTRUCTION & EXTERIOR

- Ford® Chassis - F550 - Power Stroke™ 4 X 4 Turbo Diesel / 6.7L Power Stroke V8 (S29 & X32)
- Ford® Chassis - F600 - Power Stroke™ 4 X 4 Turbo Diesel / 6.7L Power Stroke V8 (L35 & R36)
- Welded Tubular Aluminum Floor, Roof & Sidewall Cage Construction
- Premium One-Piece Domed Roof
- HD-MAX® Exterior with Partial Paint
- Automatic Leveling Jacks with Touchpad Controls
- Rotocast Storage Compartments
- Flush Mount Radius Luggage Doors
- MEGA-Storage Compartment (L35)
- Power Patio Awning with Integrated LED Lighting
- Slideout Room Awnings
- Electric Entry Step
- Automatic Courtesy Lights Over Cab Entry
- Frameless Windows
- 10,000-lb. Trailer Hitch with 7-pin Round Connector (X32)
- 12,000-lb. Trailer Hitch with 7-pin Round Connector (S29, L35 & R36)

### CONSTRUCTION & EXTERIOR OPTION

- Full-Body Paint Package with Gel Coated Sidewalls & Invisible Front Paint Protection

### AUTOMOTIVE & COCKPIT

- SYNC® 4 Enhanced Voice Recognition Communications & Entertainment System
- 8" Color LCD Capacitive Touchscreen with Swiping Capability, 911 Assist, AppLink, Smart-Charging USB Ports
- Tire Pressure Monitoring System (L35 & R36)
- AM/FM Radio, SYNC® with MyFord
- FordPass™ Connect 4G Wi-Fi Modem
- Heated/Remote Exterior Mirrors
- Rearview Mirror with Back-up Monitor
- Side View Camera System
- Emergency Engine Start Switch

- Adjustable Power Driver & Manual Passenger Captain's Chairs with Center Armrests, Headrests and Walk-Thru to Coach
- Adjustable Accelerator & Brake Pedals
- Power Windows & Door Locks
- Audible Lane Departure Warning & Pre-Collision Assist with Automatic Emergency Braking (AEB) and Forward Collision Warning
- Remote Start
- Cruise Control
- Tilt Steering Wheel
- Automatic Headlights
- Fog Lamps
- Map Light
- Powered Sky View Shade in Cab Overhead
- Keyless Entry System
- OEM Cab Floor Mats
- Privacy Curtain
- Fiberglass Running Boards
- Valve Stem Extenders
- Matte Black Wheels

### INTERIOR

- Residential Linoleum Throughout
- 84" Interior Ceiling Height
- Soft Touch Vinyl Ceiling
- LED Lighting
- Ceiling Ducted Air Conditioning System
- Baymont Cabinetry with Flat Panel Cabinet Doors & Nickel Finish Hardware
- Full Extension Soft Close Metal Ball-Bearing Drawer Guides
- Manual Roller Shades - Day/Night in Living Area & Night Shades in the Bedroom
- Leatherette Dream Dinette® Booth with Cup Holders
- Single Child Safety Tether in Dinette
- Wireless Phone Charger with USB Plug on Dinette Table Top
- Pressed Laminate Countertops in Select Areas
- Leatherette Power Reclining Theater Seating with Footrests, Heat, Massage & USB Charging Ports (X32, L35 & R36)
- Leatherette Sofa with Electric Murphy-Bed (S29)

- Electric Fireplace with Remote Control (S29)

### INTERIOR OPTIONS

- Leatherette Sofa-Bed IPO Theater Seats (X32, L35 & R36)
- Brighton Two-Tone Cabinetry with Flat Panel Cabinet Doors & Chrome Finish Hardware

### KITCHEN

- Double Door Residential Refrigerator
- 3-Burner Gas Cooktop/Oven with Bi-Fold Glass Cover
- Stainless Steel 30" Over-the-Range Microwave Oven
- Solid Surface Countertops
- Pop-Up Wireless Phone Charger with Outlets & USB Charge Ports
- Kitchen Countertop LED Accent Lighting
- Stainless Steel Double Bowl Sink with Single Handle Faucet & Pull-Down Sprayer
- Pantry
- Waste Basket
- 12-volt High Capacity Power Vent with Cover

### BEDROOM & BATHROOM

- King Size Bed (R36)
- Queen Size Bed (X32 & L35)
- Headboard, Bedspread & Pillow Shams (X32, L35, & R36)
- USB Charge Ports in Bed Base (X32, L35, & R36)
- Queen Size Murphy Bed (S29)
- USB Charge Port in Night Stand (S29)
- Bedroom 110-volt Outlet on Inverter for CPAP Machine
- Bunk Beds - Converts to Closet (R36)
- Shower with Glass Door
- Stainless Steel Bathroom Sink
- Foot Flush Toilet (S29)
- Macerator Toilet (X32, L35 & R36)
- Power Bath Vent

### ENTERTAINMENT

- 40" Smart TV on Manual Swivel above Entry Door (S29)

- 40" Smart TV on Manual Swivel in Cab-Over (L35 & R36)
- 40" Smart TV in Living Area (S29 & X32)
- 32" Smart TV in Bedroom
- USB Charge Port with TV Prep in Bunk Bed (R36)
- Exterior 32" TV on Swivel Bracket with Bluetooth® Built-in Sound Bar and Radio
- Cable TV Ready
- Satellite Mounting Backer in Roof
- Winegard® Connect™ 5.0G WiFi Extender & TV Antenna
- Exterior Kitchen with Refrigerator & Sink (R36)

### ELECTRICAL & PLUMBING

- Onan® RV QD 6000 Diesel Generator
- Automatic Generator Start
- 50-amp Detachable Shoreline Power Cord
- Automatic Transfer Switch with Power Protection
- 1800-watt Inverter
- Dual Roof Air Conditioners
- Dual Auxiliary House Batteries with Battery Tray - Holds up to Four (4) Batteries

- Battery Disconnect Switch
- 100-watt Solar Charging System with Charge Controller
- Rapid Camp+® Multiplex Electrical Control System with Bluetooth® & 7" Touchscreen
- Whole Coach Water Filtration System
- Tankless Water Heater
- Enclosed & Heated Holding Tanks (X32, L35 & R36)
- Protected Holding Tanks with Heat Pads (S29)
- Black Tank Flush System
- 360° Siphon® RV Holding Tank Vent Cap
- Washer/Dryer Combo Prep (R36)
- Outside Shower
- Exterior LP Connection

### ELECTRICAL & PLUMBING OPTION

- Solar Panel Plus+ - Includes Two (2) additional 200-watt Solar Panels (500-watts Total), Two (2) additional Auxiliary House Batteries & 30-amp Charge Controller



P.O. Box 1486, Elkhart, IN 46515  
Sales Department: 800.860.5658



Use your phone's camera to find out more information. Just scan the code!

## Specifications

	S29	X32	L35	R36
Chassis	Ford F550	Ford F550	Ford F600	Ford F600
Gross Vehicle (GVWR)	19,500	19,500	22,000	22,000
Gross Combined (GCWR)	43,000	43,000	43,500	43,500
Wheel Base	205"	227"	252"	267"
Exterior Length (w/o ladder)	30'-4"	33'-2"	35'-9"	37'-2"
Exterior Height (w/AC)	12'-6"	12'-6"	12'-7"	12'-7"
Exterior Width (w/o mirrors)	99"	99"	99"	99"
Interior Height (living area)	84"	84"	84"	84"
Awning Size	18'	14'	20'	20'
Fuel (gal)	28F / 40R	28F / 40R	28F / 40R	28F / 40R
LPG (lbs)	68.2	68.2	68.2	68.2
Fresh/Waste/Gray Water (gal)	65 / 50 / 50	75 / 40 / 47	75 / 40 / 40	75 / 40 / 40
Water Heater (gal)	Tankless	Tankless	Tankless	Tankless
Furnace (BTUs)	30,000	30,000	30,000	30,000
Exterior Storage Capacity (cu. ft.)	54	78	152	74
Hitch Weight Rating (lbs)	12,000	10,000	12,000	12,000



For a complete listing of available specifications and features, visit: [thormotorcoach.com/omni](http://thormotorcoach.com/omni)

**IMPORTANT—PLEASE READ:** This brochure reflects product design, fabrication, material, components and specifications at the date of printing, which date is disclosed below. Please visit us online at [ThorMotorCoach.com](http://ThorMotorCoach.com) or consult with your selling dealership for the latest in standards, options, specification and technical information. Photographs in the brochure may depict optional equipment or may only be available in certain floor plans. Components, appliances and the chassis may have been manufactured in a calendar year before the vehicle's designated model year. All capacities are approximate. The actual length of the vehicle may differ from that indicated in the brochure due to variances in the manufacturing processes and/or installed components. All dry weights are based on standard model features and do not include optional features or equipment. Component part and appliance manufacturers issue limited warranties covering portions of the vehicle not covered under the limited warranty we issue. Copyright Thor Motor Coach, Inc. © OH 10/02/2024